

Name and Post Office Address of Grantor Craft, Hollis T. and Bonita A.
1 Citadel Street
Piedmont, SC 29673

Toll Line or Exchange Line tributary to Greenville, SC (Name)
 (Exchange)

The Property is bounded where the line enters and leaves this property by the property of:
Citadel Street on the East
 and Pulley, Bobby Lee & Pearson on the North

Authority Greenville, SC Classification R45C
 Area Greenville, SC
 Approved [Signature]
 Title Deed by Deed.

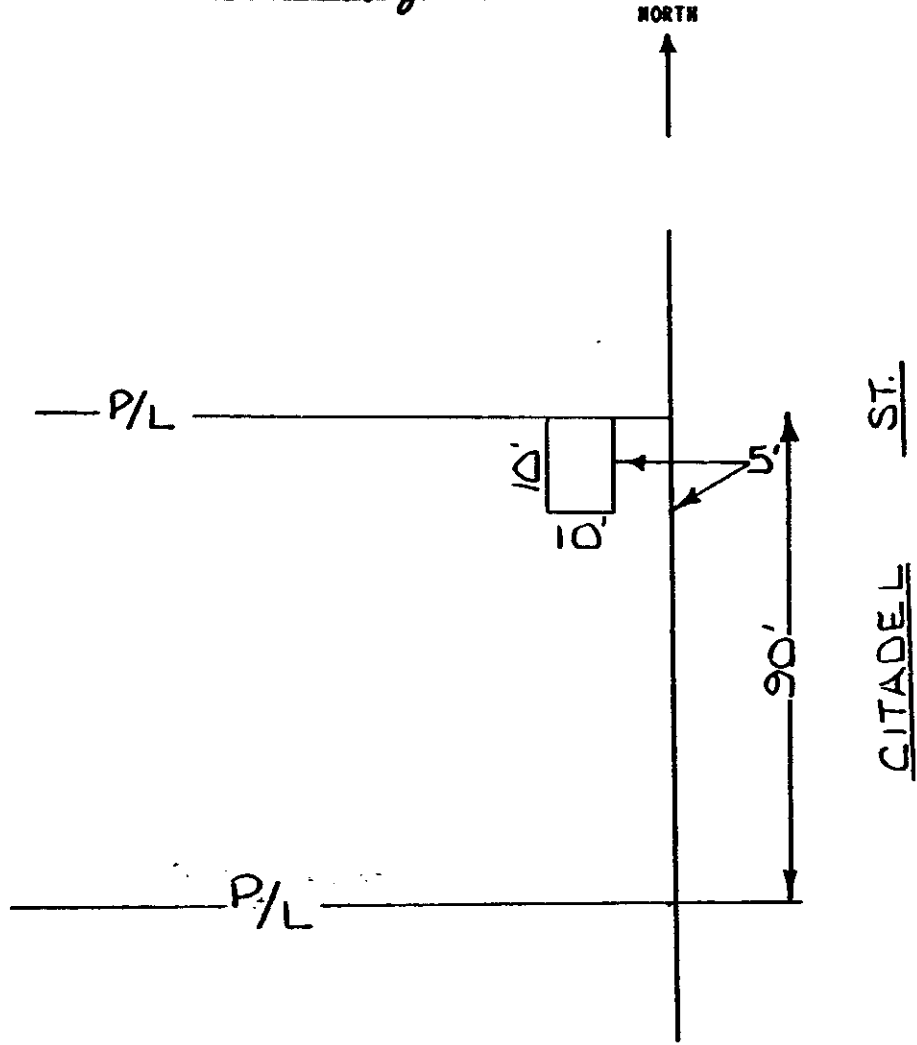

RECORDED APR 1 1982 at 10:27 A.M.

21936

Filed for record in the office of
 the R. M. C. for Greenville
 county, S. C. at 10:27 clock
 A. M. Apr. 1, 19 82
 and recorded in Deed Book
 1164 at page 847
 R. M. C. for G. Co. S. C.

APR 1 1982

REC'D
 21936
 POSTAGE
 PAID .02

mail see Encl x x

21936 RV-2